

ACOMETIDA
POWER SUPPLY

3 x 400V + N + PE	3 x 230V + PE
CABLE: 5 x 2,5 mm ²	CABLE: 4 x 2,5 mm ²
FUSE: 16A Curve D	FUSE: 20A Curve D

DEJAR SOBRENTE DE 1m
1m OVERHANG

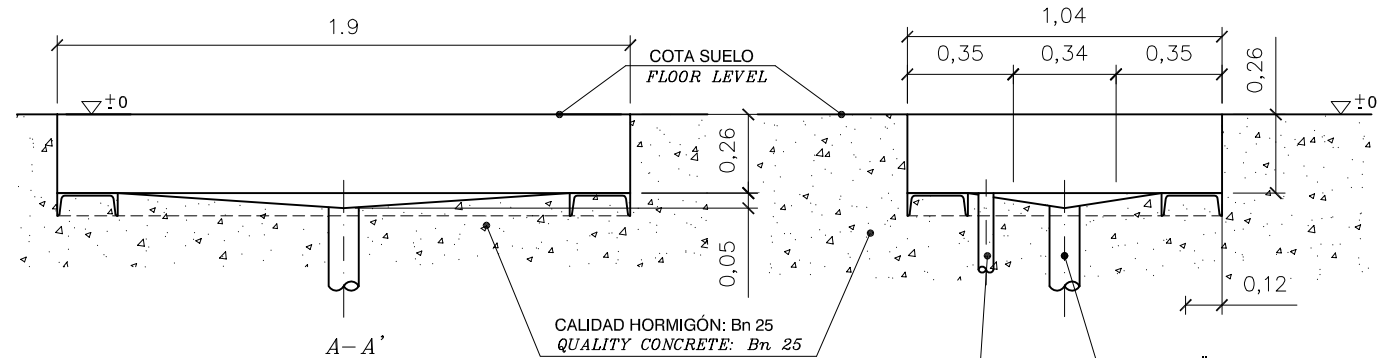
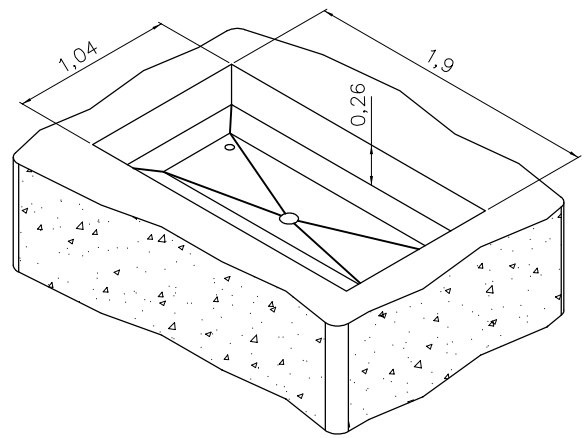

RECOMENDAMOS LA UTILIZACIÓN DE UN MARCO DE ACERO PARA PROTEGER LOS BORDES DE HORMIGÓN

WE RECOMENDED ANGLE STEEL PIT FRAME AS EDGE PROTECTION

CONDUCTO A CONSOLA Ø50 mm
NO UTILIZAR CODOS RECTOS
CONDUIT TO CONSOLE Ø50 mm
DON'T USE 90° TUB

DESAGÜE SI ES NECESARIO
Seguir las normas de salida de aguas para la construcción.

WATER DRAINAGE IF REQUIRED
Make sure that rules for drainage are in the accordance with building regulations.

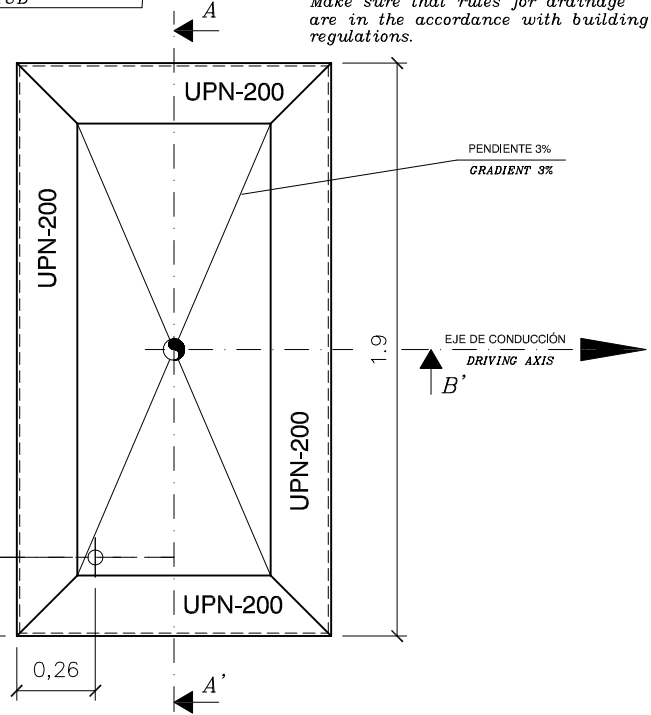

COTAS EN METROS
DIMENSIONS IN METERS

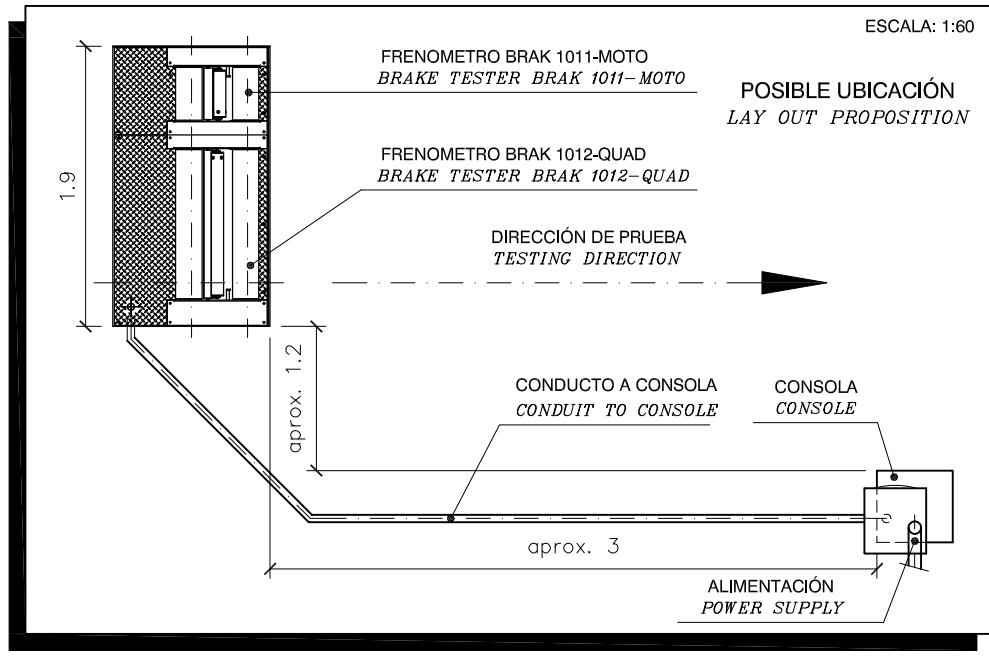

<p>VTEQ 1200 (Brak 1011-Brak 1012)</p> <p>Foundation</p>		SCALE			
		1:25			
	DRAWN:	M.Félez	12/07/13	NUMBER DRAWING:	VER.
	CHECKED:	LLG	14/01/14		